

#12

↑ North

Old W Lab

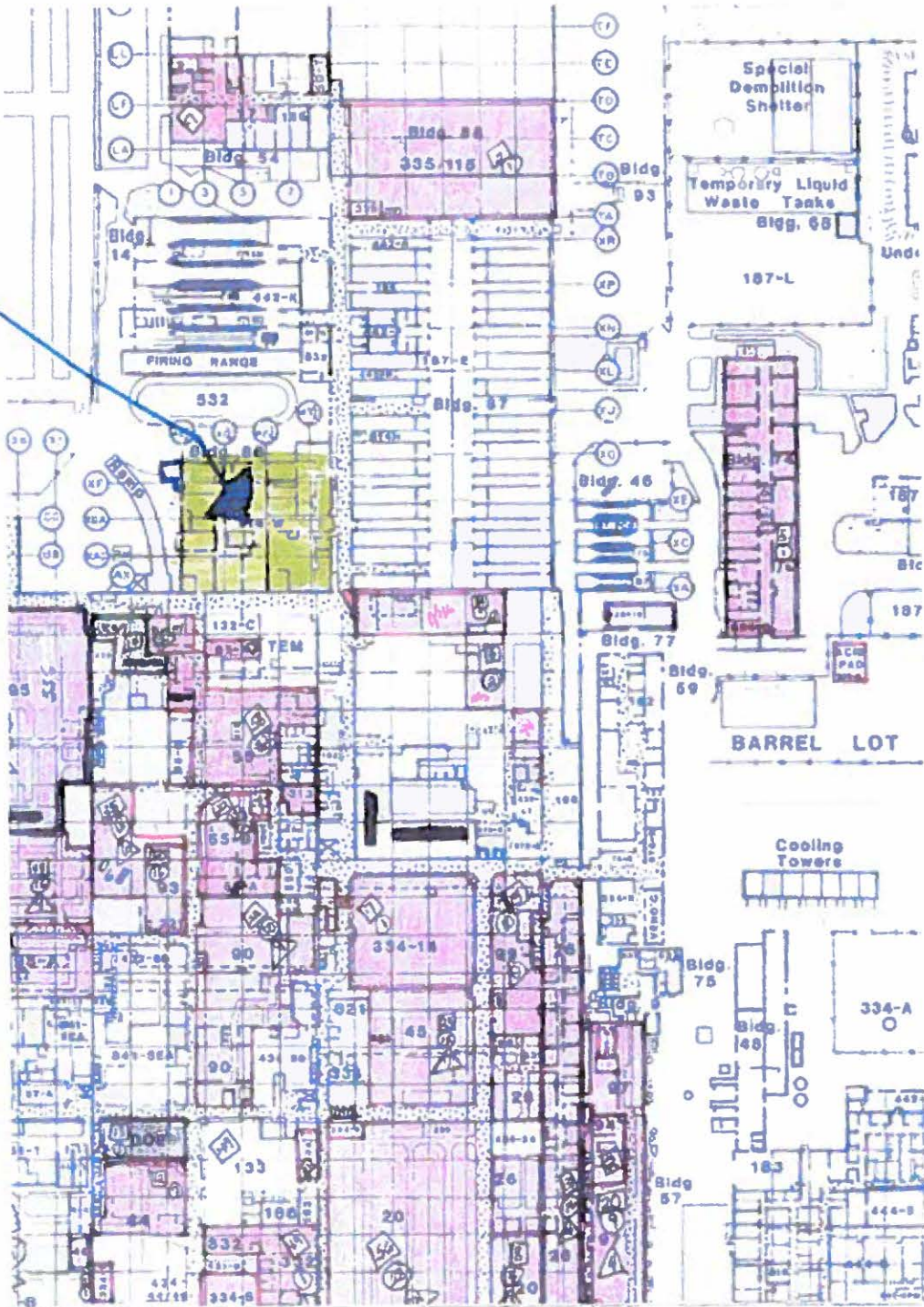

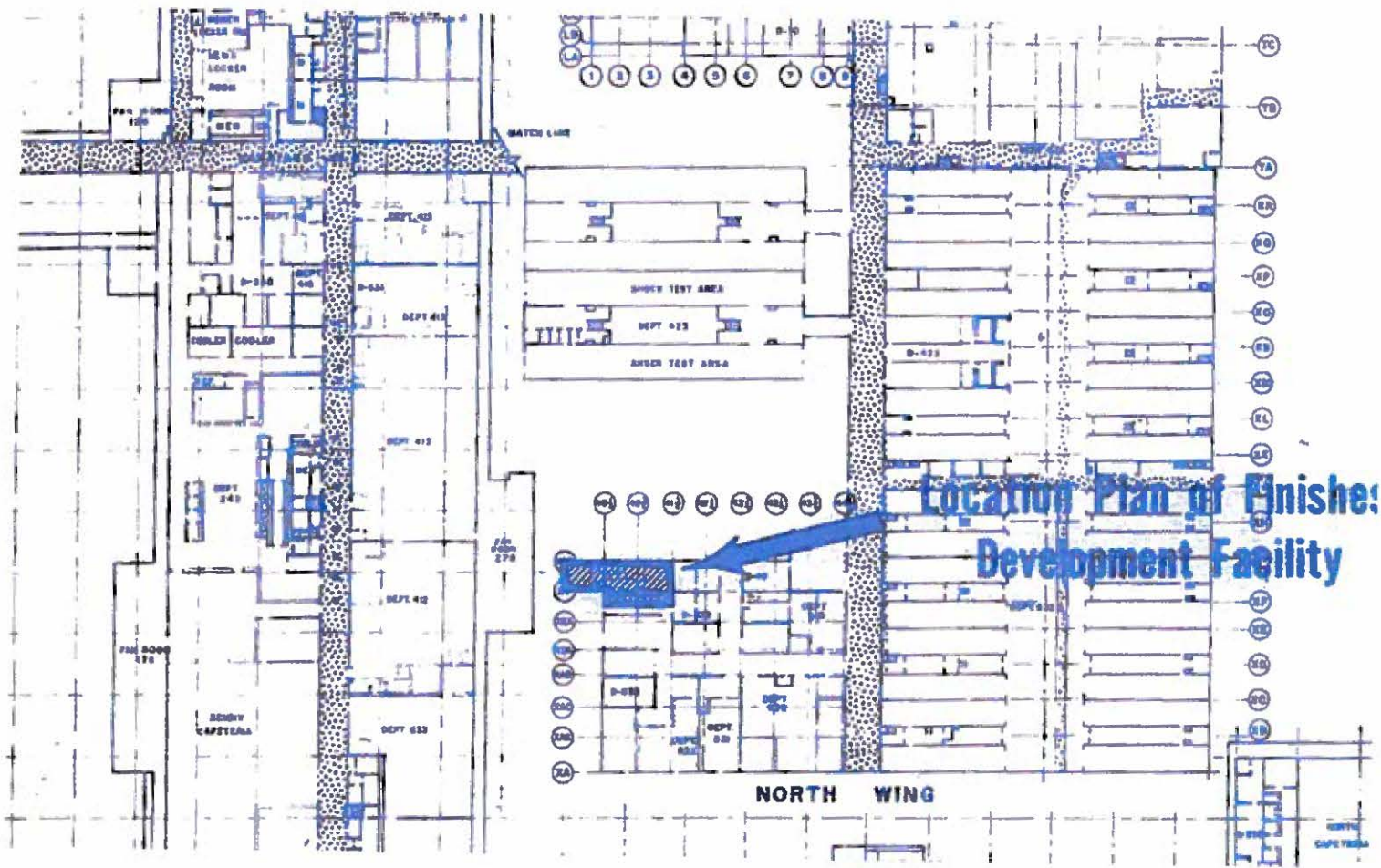

Location Plan of Finished Development Facility

↑ North

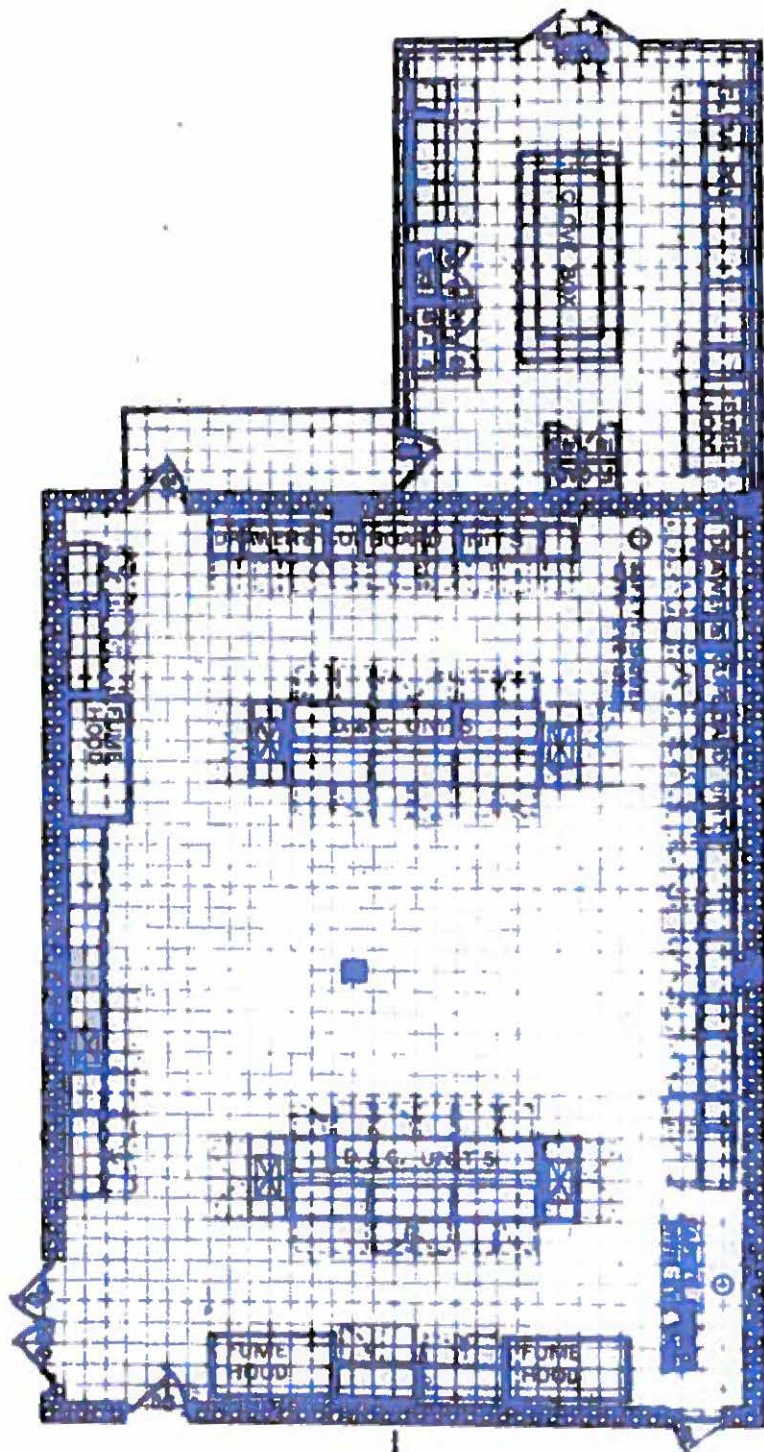

**Layout Plan of Finish
Development Facility**

Exhibit B

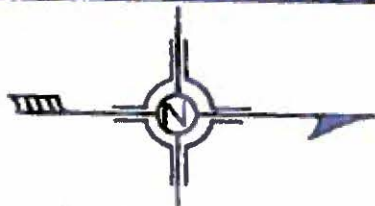

Internal
Memorandum



Kansas City
Division

Date December 23, 1969 Letter No.

Kansas City, Missouri

To File

From [redacted] D/541

Subject ALUMINUM PLATING, D/862

I. Layout of area:

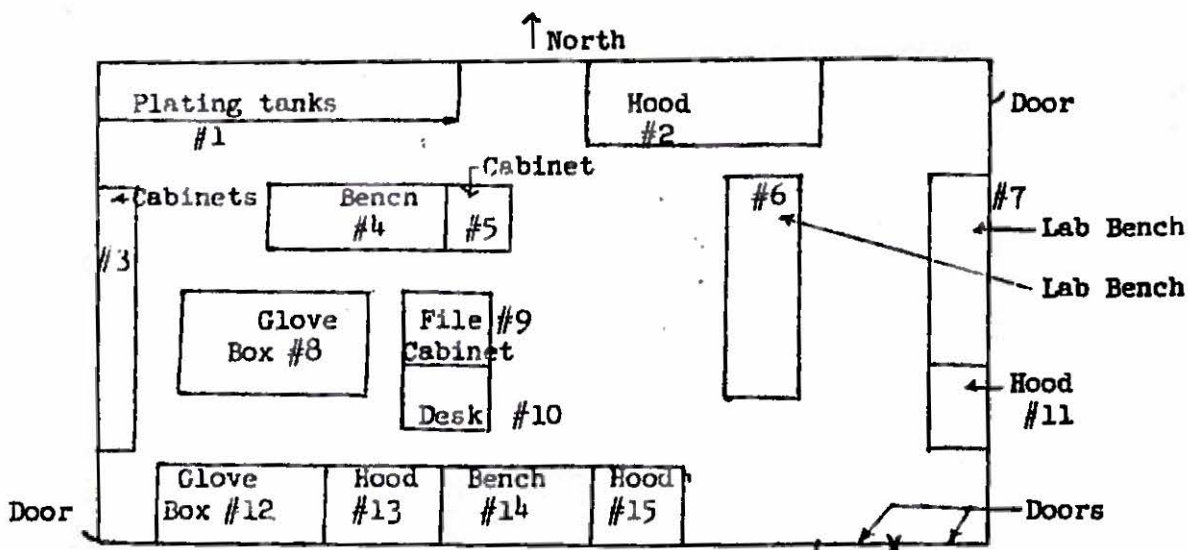

II. Shutdown of the aluminum plating activities

- A. These activities were shut down on December 18, 1969 by [redacted] as directed by [redacted]

III. Since the facility has been shut down, the following modifications have been made to provide additional protection in the area

1. All the chemical processing tanks and miscellaneous equipment at location number one have been removed and the area has been cleaned up.
2. The chemical processing tanks under the hood number two have been modified and rearranged. The solutions not necessary have been disposed of and the area has been cleaned up considerably.
3. The written procedure for aluminum plating is being re-circulated and signed off by individuals working in the area and is being posted in the area.
4. A non-explosion proof duplex receptacle in the glove box number eight has been removed.